

HV RCS 800 & 890 DIRECT MATE

RCS 890
Direct Mate
2 Way



RCS 800
Direct Mate
2 Way



RCS DIRECT MATE BENEFITS

- Cost effective thanks to unshielded terminal holder within device replacing traditional shielded headers
- Unique and safe mating screwing thanks to innovative Screw Position Assurance (SPA)
- Multiple configurations: RCS 800 (1W straight unshielded); RCS 800 (2W straight shielded); RCS 890 (2W right angle shielded)

RCS 800 & 890 DIRECT MATE FEATURES

- Robust bolt driven mate assist
- Fingersafe via plastic tips on male pins
- Cable range: ~ 50 mm² and smaller



AVAILABLE CONFIGURATIONS

Connector Type	Wire-to-device
Cable Exit Orientation	90°/180°
Cable Range	35 to 50 mm ²
Terminal Type	Round 8 mm
# of Power Terminals	2
Shielding	Individual
HVIL	Shunt on female
Assembly Assurance	SPA (Screwed Position Assurance)
Number of Indexes	2 on 890 1 on 800



APPLICATIONS

Inverter, battery, junction box, and power electric box

See back page for representative part numbers and packaging dimensions.



TECHNICAL CHARACTERISTICS

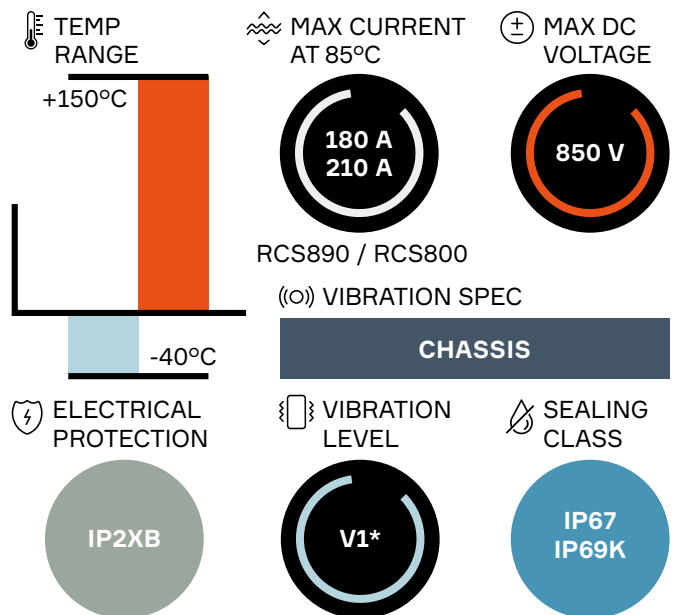

* For classification V2 please consult with your Aptiv representative

About Aptiv

Aptiv is a global technology company that develops safer, greener and more connected solutions enabling the future of mobility. Headquartered in Dublin, Aptiv has approximately 150,000 employees and operates 14 technical centers, as well as manufacturing sites and customer support centers in 45 countries.

Visit aptiv.com





PART NUMBERS**

Part number	# of ways	Gender	Terminal size (mm)	Wire range	Exit orientation	Index	Mating part number
RCS 890 Direct Mate							
35084594	2	Male	8	Pre assembled pin	90°	-	35084575
35084575	2	Female	8	35 / 50	90°	1	35084594
35084602	2	Female	8	35 / 50	90°	2	35084594
RCS 800 Direct Mate							
35098453	2	Female	8	35	180°	1	35099885
35099885	2	Male	8	Pre assembled pin	180°	-	35098453
35099880*	2	Male	8	Without pin	180°	-	35098453

* with HVIL

** Please see full list of configurations in the Aptiv High Voltage Catalogue



ASSOCIATED PARTS

RCS 890 Direct Mate

Part number	Description
35082392	Female 890 terminal
15549848	DSQ 1.5 female Ag
60993928	SWS for DSQ terminal
35082415	Outer ferrule 35 and 50 mm ²
35084603	Recovery shield 35 and 50 mm ²
35084610	Cable seal device for 35 mm ²
35084586	Cable seal device for 50 mm ²

RCS 800 Direct Mate

Part number	Description
13893887	Female 800 terminal
15441379	SWS for DSQ terminal
35082415	Outer ferrule 35 and 50 mm ²
35082410	Inner ferrule 35 and 50 mm ²
35099247	Cable seal device for 35 mm ²
35092416	Tube
15549848	DSQ 1.5 female Ag



DIMENSION MEASUREMENT SAMPLE

RCS 890 Direct Mate

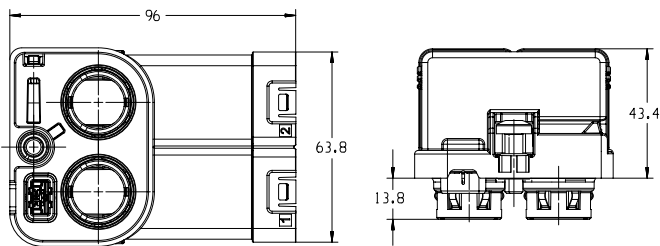

35084575

RCS 800 Direct Mate

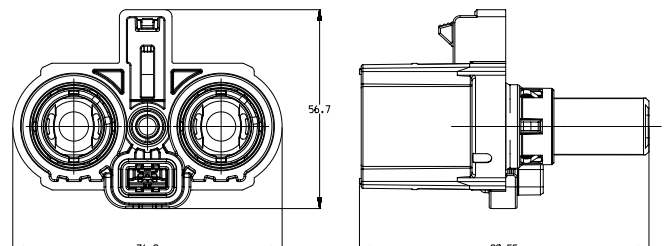

35098453

Part numbers, specifications, dimensions and performance data in this document are for general references only and are subject to change without notice. To verify product information, please contact an Aptiv representative.

CS-SP91-HV-En0219

• APTIV •

aptiv.com | © 2019 Aptiv. All rights reserved